

## Single Beam Installation

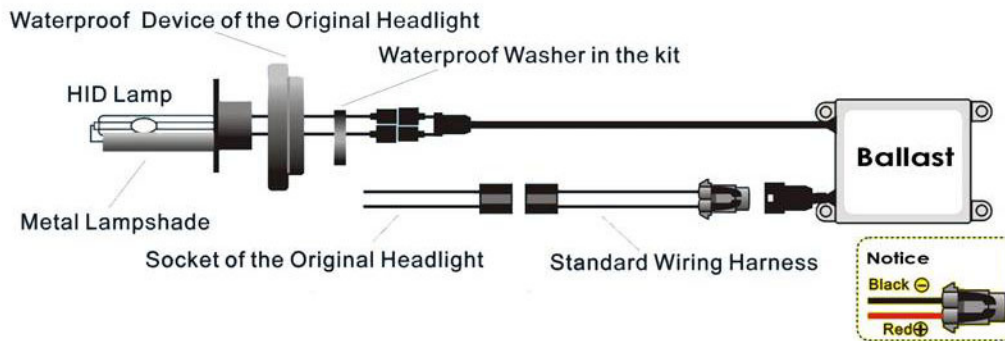

## H4, 9003, 9004, 9007, 9008, H13 Hi/Lo Installation

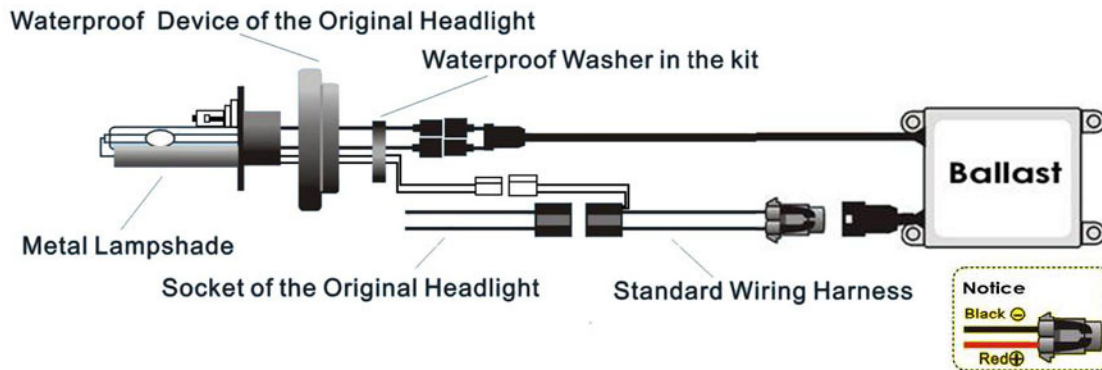

## How to reverse the Polarity (positive/negative) for your HID Kit.

After installation of the HID system on your vehicle, if the HID light could not be turn on, you may need to reverse the polarity in order to have the HID system to work properly. Please try both method to make it to work.

### Method 1

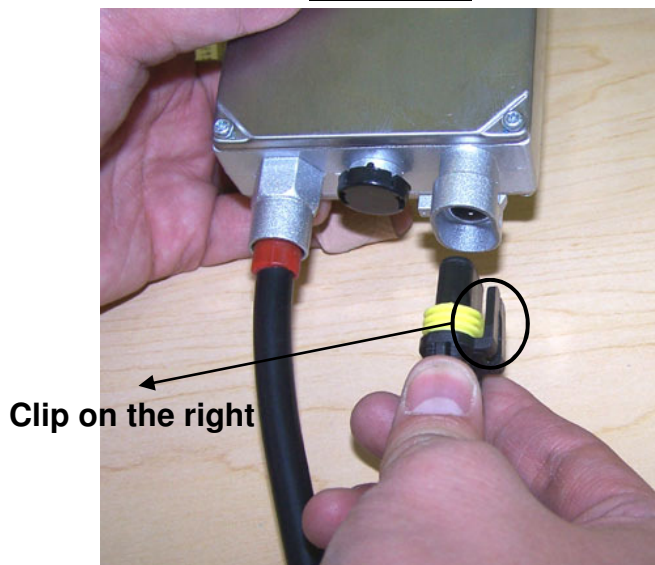

### Method 2

